



Features

- Low cost
- Dielectric strength: 1500 Vrms
- Fixed pin spacing allow easy PCB insertion
- Operating temperature: -40 to +125°C
- Custom Designs Available

Application

- DC/DC, AC/DC line noise suppression
- Automotive Systems
- Communication System

► Dimensions & Configurations (Unit:mm)

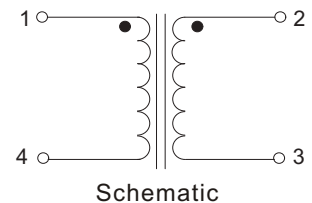
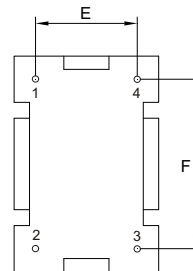
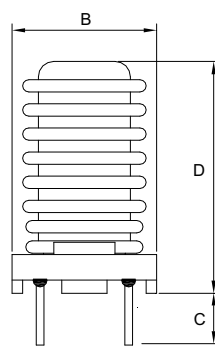
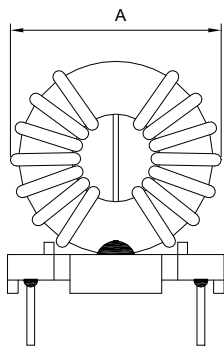

Type	A	B	C	D	E	F
CTR1409	17.5 Max.	13.0 Max.	3.0±0.5	22.0 Max.	5.0±0.5	7.7±0.5

► Electrical Characteristics For CTR1409 Series

Part Number	Inductance [mH]	Rated Current [A]	DCR(max) [mΩ]
CTR1409-102N	1.0±30%	3.0	35
CTR1409-222N	2.2±30%	2.0	70
CTR1409-332N	3.3±30%	1.5	120
CTR1409-103N	10.0±30%	1.0	360
CTR1409-203N	20.0±30%	0.5	540

1. Inductance is per winding, measured with a LCR meter 4284A at 10KHz
2. Nominal Voltage: 250VAC
3. Electrical specifications at 25°C